

# JVC

D-ILA PROJECTORS

DLA-X900R

DLA-X700R

DLA-X500R

DLA-X35



**4K**  
e-shift3



## DLA-X900R

4K-resolution D-ILA Projector



- Industry's highest dynamic contrast ratio: 1,500,000:1\*
- Industry's highest native contrast ratio: 150,000:1\*
- Brightness: 1,300 lumens

\*As of November 1, 2013 JVC data.



## DLA-X700R

4K-resolution D-ILA Projector



- Dynamic contrast ratio: 1,200,000:1
- Native contrast ratio: 120,000:1
- Brightness: 1,300 lumens



## DLA-X500R

4K-resolution D-ILA Projector



- Dynamic contrast ratio: 600,000:1
- Native contrast ratio: 60,000:1
- Brightness: 1,300 lumens

## Projection Distance Chart

Display size (16:9)			Projection distance	
Screen diagonal (inch)	W (mm)	H (mm)	Wide (m)	Tele (m)
60	1,328	747	1.78	3.66
70	1,549	872	2.09	4.28
80	1,771	996	2.40	4.89
90	1,992	1,121	2.70	5.51
100	2,214	1,245	3.01	6.13
110	2,435	1,370	3.31	6.75
120	2,656	1,494	3.62	7.36
130	2,878	1,619	3.92	7.98
140	3,099	1,743	4.23	8.60
150	3,320	1,868	4.53	9.22
160	3,542	1,992	4.84	9.84
170	3,763	2,117	5.14	10.45
180	3,984	2,241	5.45	11.07
190	4,206	2,366	5.75	11.68
200	4,427	2,490	6.06	12.30

\*Projection distances are design specifications, so there is  $\pm 5\%$  variation.

## Optional Equipment



### PK-L2312U

User-replaceable Lamp

Not suitable for household room illumination



### PK-AG3

RF Method  
3D Glasses



### PK-EM2

RF Method  
3D Synchro Emitter

## Connectors



DLA-X900R/X700R/X500R



DLA-X35

## Specifications

		DLA-X900R	DLA-X700R	DLA-X500R	DLA-X35
Device		0.7 inch Full HD D-ILA (1920 x 1080) x3			
4K e-shift3 Technology		●			
Resolution		3840 x 2160*1			1920 x 1080
Lens		x2 Zoom & Focus: Motorised; f=21.4-42.8mm / F3.2-4			
Lens Shift		$\pm 80\%$ Vertical and $\pm 34\%$ Horizontal (motorised)			
Projection Display Size		60 inch – 200 inch (diagonal)			
Light Source Lamp		NSH 230W (lamp life: approx. 4,000 hours when the lamp is in Low mode)			
Brightness		1,300 lumens*2			
Contrast Ratio	Dynamic	1,500,000:1	1,200,000:1	600,000:1	—
	Native	150,000:1	120,000:1	60,000:1	50,000:1
Input Terminal	Component	—			1 (RCA;Y,Pb/Cb,Pr/Cr)
	HDMI	2 (3D/Deep Colour/CEC compatible)			
Output Terminals	Trigger	1 (Mini jack, DC12V/100mA)			
	3D Sync	1 (Mini DIN 3pin)			
Control Terminals	RS-232C	1 (D-sub 9pin)			
	Remote	—			1 (Mini jack)
	LAN (RJ-45)	1			
Video Input Signal Format	Digital	480p, 576p, 720p 60/50, 1080i 60/50, 1080p 60/50/24, 3840 x 2160p 60/50/30/25/24, 4096 x 2160p*3 24			480i/p, 576i/p, 720p 60/50, 1080i 60/50, 1080p 60/50/24
	Analogue	—			480i/p, 576i/p, 720p 60/50, 1080i 60/50
PC Input Signal Format (HDMI)		VGA/SVGA/XGA/WXGA/FWXGA/WXGA+/SXGA/WXGA++/WSXGA+/WUXGA			VGA/SVGA/XGA/WXGA/WXGA+/SXGA/WXGA+/WUXGA
3D Format	Frame Packing	720p 60/50, 1080p 24, 1080i 60/50			
	Side-by-Side (half)	720p 60/50, 1080p 60/50/24, 1080i 60/50			
	Top & Bottom	720p 60/50, 1080p/24			
Power Consumption		360W (Normal standby: 7W, Eco-mode standby: 0.4W)			330W (Normal standby: 0.8W, Eco-mode standby: 0.4W)
Fan Noise		21dB (When the lamp is in Low mode)			23dB (When the lamp is in Low mode)
Power Requirement		AC110V-240V, 50/60Hz			
Dimensions (W x H x D)		455mm x 179mm x 472mm			
Weight (net)		15.0kg	14.7kg	14.8kg	

\*1 Resolution is 1920x1080 at 3D mode.

\*2 Measurement, measuring conditions, and method of notation all comply with ISO 21118.

\*3 When the video input signal is at 4096 x 2160p, data above 3,840 is not displayed equally on the left and right.

## External Dimensions (unit: mm)

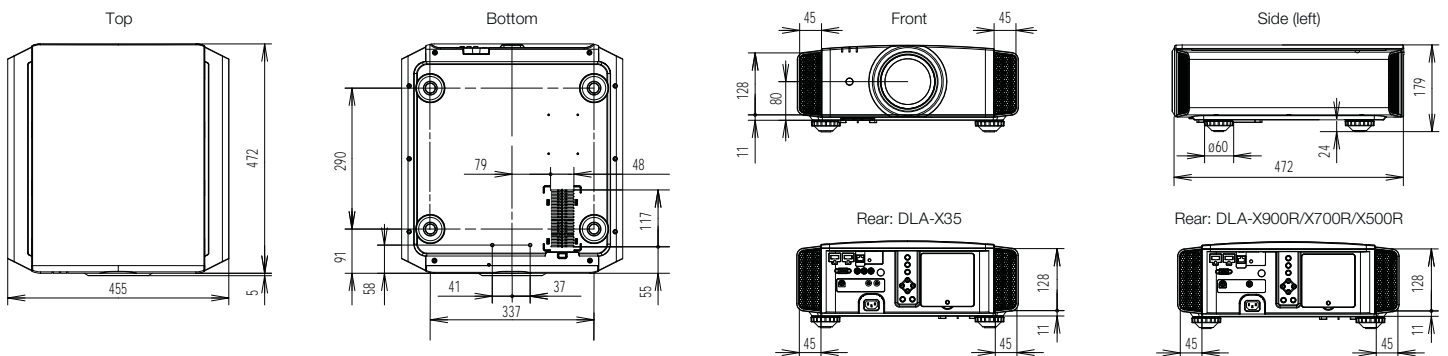

• D-ILA is a registered trademark of JVC KENWOOD Corporation. • e-shift is a registered trademark of JVC KENWOOD Corporation. • The projector is equipped with an ultra-high pressure mercury lamp, which may break, emitting a loud noise, when it is subjected to shock or after it has been used for some length of time. • Please note that, depending on how the projector is used, there can be considerable difference between individual lamps regarding how many hours they will operate before requiring replacement. • An additional payment is required for installation of a new lamp, if necessary. • The projector lamp requires periodic replacement and is not covered by warranty. • Please be aware that, because the D-ILA device is manufactured using highly advanced technologies, 0.01% or fewer of the pixels may be non-performing (always on or off).

Design and specifications are subject to change without notice. All pictures on this brochure are simulated. Adobe is a trademark or registered trademark of Adobe Systems Incorporated in the U.S. and/or other countries. ISF is a registered trademark of Imaging Science Foundation, Inc. THX and THX logo are trademarks of THX Ltd., which may be registered in some jurisdictions. HDMI, the HDMI logo and High-Definition Multimedia Interface are registered trademarks of HDMI Licensing LLC. All other brand or product names may be trademarks and/or registered trademarks of their respective owners. Any rights not expressly granted herein are reserved.

Copyright © 2013, JVC KENWOOD Corporation. All Rights Reserved.

# JVC

DISTRIBUTED BY

www.jvc.eu

Printed in Belgium

CCZ-3734-13

"JVC" is the trademark or registered trademark of JVC KENWOOD Corporation.